

INSTRUCTIONS FOR USE

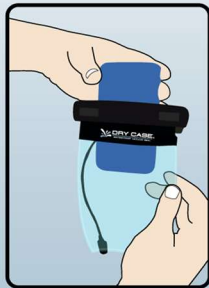

1.) Slide in your device –

Twist the clasps outward to open the DryCASE®, and then simply slide in the device that you would like to protect. Make sure that the contents inside are completely clear of the opening and the closure. Enjoy music by plugging in the headphone jack to your device.

2.) Lock the closure shut –

Twist the clasps inward to close and lock the DryCASE®. Position your device how you would like to use it inside the DryCASE®. When you remove the air creating a vacuum it will secure the device in place. Be sure the top closure is completely closed and locked. If you want to use the armband, slide it through the slot located on back of the case.



3.) Pump out all the air –

Simply squeeze the pump until you have removed all the air and can't pump it any more. After you have removed all the air the DryCASE® should be tightly sealed around the contents inside and the pump should be completely flat. You can now remove the hand pump and place the safety cap on.



Observe the DryCASE for 10 minutes after you have pumped out all the air, making sure the vacuum is intact. The DryCASE should remain tightly sealed over your device. Once all the air is removed there is no way water can get in.